

# NEUROVEEN™

Natural Relief Tablets for Nerve Pain & Troubled Mobility\*

Dear Valued Customer,

Thank you for choosing Neuroveen, a natural homeopathic blend for the temporary relief of nerve pain and related symptoms such as weakness and troubled mobility.\* Please carefully read directions for use below:

## IMPORTANT! PLEASE READ!

- Safe for ages two and up.
- Keep out of reach of children.
- If pregnant or breastfeeding, take only as directed by your physician.
- Product must not come into contact with metal.
- Store in a cool, dry place.
- Do not store next to electrical devices or appliances
- If tamper-resistant seal is broken, do not use.
- Use within 60 days of opening.

### DOSAGE GUIDE

Weight	Daily Dosage Size
50 lbs. or less	½ tablet twice daily
50+ lbs.	1 tablet twice daily

**Usage:** Chew or dissolve tablets in your mouth. For children, crush tablets and sprinkle onto tongue.

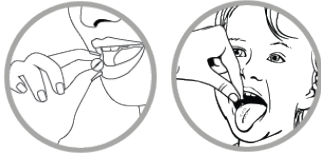

**Regimen Jump-Start & Symptom Flare-Ups:** You may safely increase dosage up to 3x daily until symptoms improve or as directed by your physician. Excessive dosage may cause mild digestive discomfort.

**Prescription Medications:** Neuroveen may be used safely with other OTC or prescription medications. However, as with any changes in your health regimen, we recommend you inform your doctor of your choice to use Neuroveen.

**Side Effects:** Neuroveen is a homeopathic medication. According to NCCAM, "homeopathic remedies in high dilution, taken under supervision of trained professionals, are generally considered safe and unlikely to cause severe adverse reactions."

Though there is little evidence for it in clinical studies, some individuals express concern about a phenomenon called "homeopathic aggravation." According to homeopathic practitioners, this a rare side effect - occurring when a remedy is particularly well-matched to a patient - in which there is a temporary worsening of symptoms after beginning treatment with a homeopathic medicine. If you believe you are experiencing homeopathic aggravation, we recommend halving your dose size until symptoms subside.

If you believe you are experiencing a rare side effect or allergic reaction to Neuroveen, please discontinue use, consult your healthcare professional immediately, and then contact our customer service department.

**Keep with the Program:** We encourage you to take Neuroveen twice daily for at least 30 days alongside a healthy diet and exercise regimen. Keep a detailed journal to evaluate your progress. To share your results with us, please visit [www.hellolife.net/reviews](http://www.hellolife.net/reviews) or email us at [service@hellolife.net](mailto:service@hellolife.net) and let us know how we're doing.

**We Guarantee Satisfaction with Neuroveen.** Please visit [www.hellolife.net/terms-of-service/](http://www.hellolife.net/terms-of-service/) for a copy of our return policy.

FDA PRODUCT LISTED NDC# 49726-044-60

\*Product indications based on the Homeopathic Materia Medica.

Thank you for choosing Neuroveen!



Customer Service: 1.800.875.0850

International: 1.616.803.7880

Email: [service@hellolife.net](mailto:service@hellolife.net)

[www.hellolife.net](http://www.hellolife.net)

4635 40<sup>th</sup> St SE  
Grand Rapids, MI 49512

Rev 1-9-20